

Henson G. Westall-Andrew E. Westall-Thomas Henrie Westall Bell Grove Plantation
Brazosport Archaeological Society

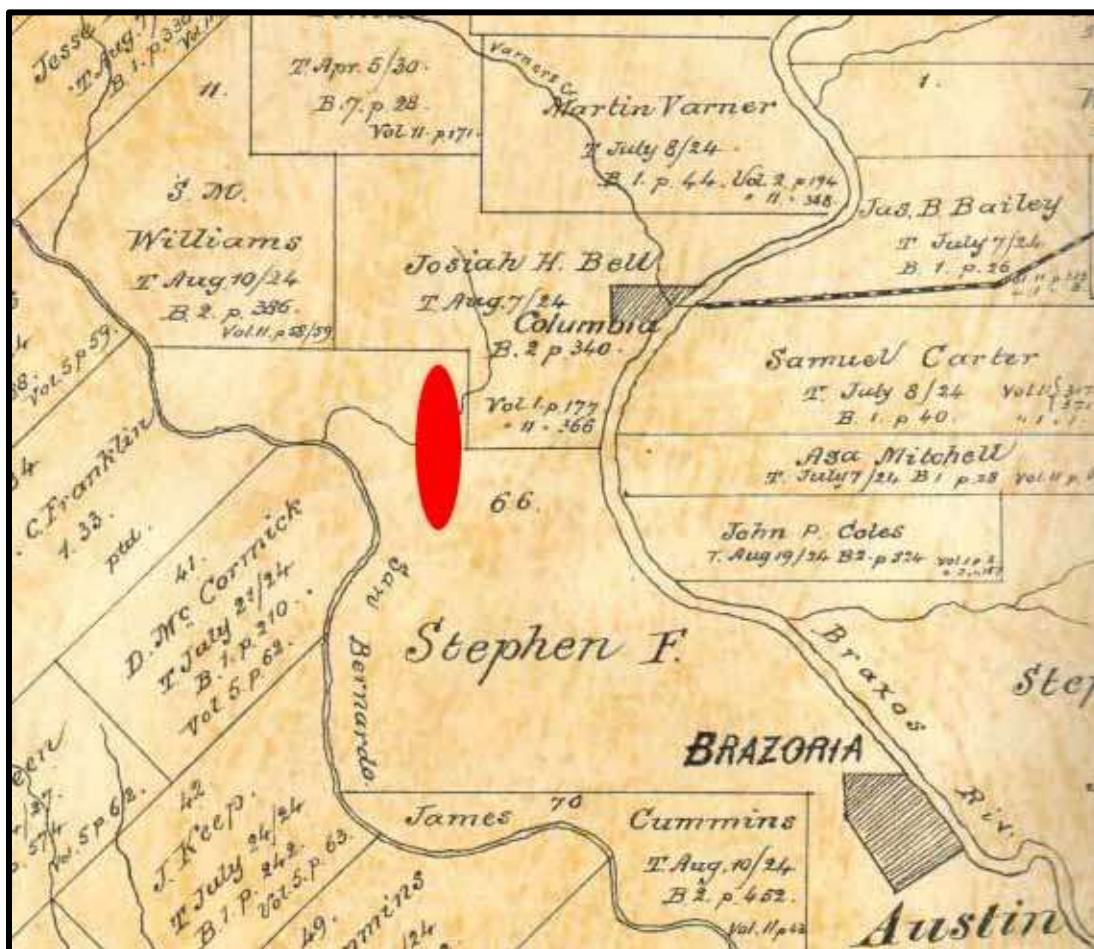

Stephen F. Austin 7 1/3 League Map 1879 The General Land Office of the State of Texas

Being a member of Stephen F. Austin's original 300 families, Thomas Westall brought his family from Tennessee in 1825 and settled near San Felipe de Austin. He made arrangements through Henry Austin to buy land in Brazoria County on the west side of the Brazos River in the lower part of the Stephen F. Austin 7 1/3 League and moved there ~1828, building a cotton plantation. In 1832 Thomas and two of his sons, James M. and Andrew E. Westall took part in the Battle of Velasco. Thomas Westall perished in the cholera epidemic of 1833 along with two of his children, James M. and Emeline. Andrew E. Westall took control of the Westall plantation consolidating the holdings of his siblings and purchasing adjacent lands. His younger brother Henson G. Westall turned over his interest in the family homestead. Their sister Eliza M. Hill gave 730 acres out of the upper part of Stephen F. Austin 7 1/3 league tract west of the Brazos River to Henson G. Westall October 1842.¹

Henson G. Westall had wed the widow Harriet D. Ferguson February 23, 1842. They would have two children, Andrew E. and Eliza, who reached maturity. Harriet's death July 4,

¹ Brazoria County Deed Records: D 432/34

1849 came a few days after the birth of their third child which also did not survive. Dr. P. A. Davenport had been in attendance. Dr. Davenport was the physician for the plantation from 1848 until September 1852.

Henson G. Westall built a cotton plantation using a small number of slaves. According to the 1850 Slave Census he owned 16 slaves.



Map Courtesy of the Brazoria County Historical Museum 1983.010c.0005

The Henson G. Westall household was listed in the 1850 Federal Census:

| | | | |
|-------------------|-----------|-----|-------------------|
| Henson G. Westall | Farmer | 30M | Tennessee |
| Andrew E. Westall | | 5M | Texas |
| Eliza M. Westall | | 3F | Texas |
| V. Mason | Carpenter | 70M | District Columbia |
| William R. Lewis | Lawyer | 48M | Pennsylvania |
| Eliza B. Lewis | | 41M | Mississippi |
| Louisa E. Lewis | | 20F | Mississippi |
| Cora Lewis | | 19F | Louisiana |
| Stella Lewis | | 18F | Florida |
| Earnest Arson | | 4M | Texas |

According to the 1850 agricultural census Henson G. Westall had 250 improved acres and 4490 unimproved acres with \$1000 worth of farm machinery. He owned 16 horses, 40 milch cows, 10 work oxen, 300 head of cattle, 50 sheep, and 200 hogs. The plantation produced 800 bushels of corn, 50 of Irish potatoes, 1000 of sweet potatoes, 316 pounds of butter, and 35 bales of cotton in 1849. In March 1850 Westall bought 400 acres adjacent to his plantation which had been the Copes place for \$2400.² John K. Pilant had been hired as overseer for 1851-1852.

J. H. Brower & Co. of New York sold 69 bales of cotton at average weight of 388 lbs. from Westall's 1852 crop for \$2598.70 from which was netted \$1930.67.

In 1851 Henson G. Westall married Emily T. Yerby in Galveston, Texas. They had one child Ann McNeel Westall born June 22, 1852 before Henson G. Westall died at Bell Grove plantation January 27, 1853. On his death bed he gave a nuncupative will in the presence of seven witnesses:

My wife Emily Westall and my Infant daughter Ann McNeel Westall, I desire to be equal heirs with my two children Andrew and Eliza. I desire my brother Andrew E. Westall to raise my son Andrew if he wishes to do so—I wish my daughter –Eliza as soon as she is old enough to be sent to McCullough's School at Galveston and I desire that both of my children be well educated according to my means. I wish Major Robert Yerby to have the Copes Place at what it cost me...³

Henson G. Westall had entered into partnership with Robert M. Yerby, his father-in-law, for about one year. Robert M. Yerby did take possession of the Copes place. Henson G. Westall's estate was valued at \$30,095. This included his plantation of 730 acres, the old Copes place of 400 acres, other miscellaneous acreage in other counties, 16 slaves, livestock, personal items and 70 light bales of cotton. By April 1854 debts against the estate were listed at \$6555.14. In November 1854 the plantation was sold to Andrew E. Westall \$12.50/acre. This sale was never confirmed by the probate court. The estate was initially handled by William G. Hill. For the year 1855 all the slaves were hired out. Andrew E. Westall took over the estate in 1856.⁴

Emily Westall married Henry C. Lloyd April 25, 1854 and for the year 1854 she received an annual allowance of \$800. She petitioned the Henson G. Westall's estate to partition his property and did receive a number of slaves.

In March 1852 Elizabeth M. Westall and an unnamed infant died, leaving four young children for Andrew E. Westall to raise. Andrew E. Westall became the legal guardian for both Andrew and Eliza and the legal guardian of his own children who had inherited a large estate from their grandfather Major Arthur Henrie with lands in Liberty and Zavala counties.⁵ In February 1855 Andrew E. Westall wedded Mary M. Bates, daughter of Joseph and Rosa Bates, who was over twenty years younger than he. They shortly began their own family as six children would be born to their union (See Appendix A).

For the next couple of years Andrew E. Westall tried to sell the Bell Grove plantation:

² BCDR: D 355/56 & D 356/57

³ Record of Wills: B 119

⁴⁴ Henson G. Westall Probate Case #512, Brazoria County Clerk's Office, Angleton, Texas

⁵ Probate Records Case #511 Adelia, Anna Eliza, Charlotte K. and Thomas H. Westall Minors, County Clerk's Office, Brazoria County Courthouse, Angleton, Texas

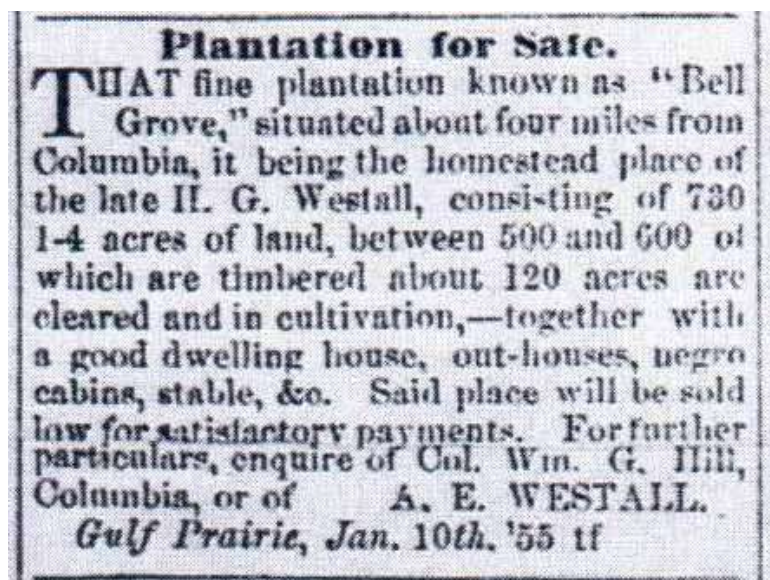

Evidently Andrew E. Westall was unable to sell Bell Grove Plantation. Operating the plantations he owned came at a price; in May 1857 he had to mortgage both his plantations and 36 slaves as security for a \$23,680.05 note to Pierce & Bacon of Boston, Massachusetts.⁷ The household at the Westall plantation listed in the 1860 Federal Census:

| | | |
|-------------------|------|------------------------------|
| A. E. Westall | 46M | Tennessee |
| Mary Westall | 24 F | Alabama |
| Thomas H. Westall | 17M | Texas (1 st wife) |
| Adelia Westall | 14 F | Texas (1 st wife) |
| Lotte Westall | 12 F | Texas (1 st wife) |
| Richard Westall | 3M | Texas (2 nd wife) |
| Mary Westall | 1 F | Texas (2 nd wife) |
| Andrew Westall | 16M | Texas (Nephew) |
| Eliza Westall | 13 F | Texas (Niece) |

Andrew Westall was educated at Reutersville College near La Grange, Texas and Austin College in Huntsville, Texas, while Eliza went to Chappell Hill in Washington, County paid by their father's estate. Both children when they reached a legal age petitioned the probate court for new administrators for their estate to replace their Uncle Andrew E. Westall and their requests were granted. Andrew had paid the estate for the use of his brother's slaves but charged the estate for administrative duties, housing the children and all their sundry needs while not being quick to send cash which the children often requested.⁸

Post Civil War Andrew E. Westall died January 1869. Andrew and his sister Emily Westall sold the Bell Grove plantation to Isaac T. Tinsley in October 1869 with Tinsley clearing the original mortgage held by Morgan L. Smith.⁹

⁶ *The Democrat and Planter*, July 8, 1856, West Columbia, Texas

⁷ Brazoria County Deed Record: H 167/71

⁸ Probate Records Case 636 Andrew E Westall Jr. & Eliza Westall Minors & Case 512 Henson G. Westall, Brazoria County Clerk's Office, Brazoria County Courthouse, Angleton, Texas

⁹ BCDR: M 13/15

Isaac T. Tinsley gifted the property to his daughter Annie Tinsley Westall, who had married Thomas H. Westall in 1868.¹⁰ The family of Thomas H. Westall was listed in the 1870 Federal Census:

| | | | |
|----------------|--------|--------|-------------|
| Thomas Westall | Farmer | 26M | Texas |
| Ann Westall | | 21F | Texas |
| Mary Westall | | 10/12F | Texas |
| Clara Addison | | 8F | Texas |
| John Terry | | 21M | Mississippi |

The 1870 Agricultural Census lists Thomas H. Westall as having 150 improved acres with another 600 acres unimproved. He owned 9 horses, 6 mules, 1 milch cow, 4 sheep, and 15 hogs. The plantation produced 1000 bushels of corn.

In December 1876 Thomas H. Westall died. A few years later his wife married Abram Cross a civil engineer from Houston, Texas. They would move the family to Houston. The Abram Cross family in 1880:

| | | |
|----------------|-----|---------|
| Abram Cross | 42M | Ireland |
| Annie Cross | 31F | Texas |
| Arthur Westall | 8M | Texas |
| Ernest Westall | 4M | Texas |

In 1896 Annie Westall Cross gave the plantation now containing 637 acres to her two sons, Arthur and Ernest.¹¹ The two sons would marry but did not farm the plantation. After the turn of the century they both sold out their interests and the plantation was broken up into tracts to be sold off.

None of the area of the Bell Grove plantation has been surveyed archeologically. The graves of Henson G. Westall, Harriet Westall, and their infant child could be buried on the property. The infant daughter of Thomas and Ann Westall, Mary, could also be buried there.

¹⁰ BCDR: N 35/36

¹¹ BCDR: 47 635/36

Appendix A

Thomas Westall Family Genealogy

- Thomas Westall b. England ~1775 (Andrew Westall & ? Locksley)
 d. August 1833 Brazoria County, Texas (Cholera)
- m.
 Sarah Henry b.
 d. February 2, 1834 Brazoria County, Texas (Pulmonary Complaint)
- A. Elizabeth Martha Westall b. 1807 North Carolina ? (Father Arthur Henrie)
 d. June or July 1847 Waverly Plantation, Brazoria County, Texas
 married 1st March 20, 1828 San Felipe de Austin, Texas
- James Elijah Brown Austin b. October 3, 1803 Potosi County, Missouri
 d. August 17, 1829 New Orleans, Louisiana
1. Stephen Fuller Austin II b. February 1829 Brazoria County, Texas
 d. February 1837 Waverly Plantation, Brazoria County, Texas
- married 2nd May 1831 Brazoria County, Texas
- Zeno Phillips b. ?
 d. May 22, 1835 (Quintana ?, Brazoria County, Texas)
1. Sarah Olivia Phillips b. Waverly Plantation
 d. Sept. 10, 1841 Waverly Plantation, Brazoria County, Texas
- married 3rd February 25, 1836 Brazoria County, Texas (his 2nd marriage)
- William Green Hill b. 1802 Franklin Co., North Carolina (Jordan Hill and Mary Nancy Green)
 d. June 30, 1860 Osceola Plantation, Brazoria County, Texas
1. William G. Hill Jr. b. 1838 Waverly Plantation, Brazoria County, Texas
 d. November 10, 1869 Osceola Plantation, Brazoria County, Texas
- married September 27, 1861
- Elizabeth C. Burney b.
2. Ann E. Hill b. 1839 Waverly Plantation, Brazoria County, Texas
 married October 1, 1857 Brazoria County
- Dr. Robert H. Boxley b. 1831 Virginia
 d. January 17, 1896 Hempstead, Texas
3. James W. Hill b. 1840 Waverly Plantation, Brazoria County, Texas
 d. ?
4. Aneas E. Phelps Hill b. 1842 Waverly Plantation, Brazoria County, Texas
 d. 1867
5. John B. Hill b. August 4, 1845 Waverly Plantation, Brazoria County, Texas
 d. October 31, 1899 Houston, Harris County, Texas
- married February 19, 1867 Fort Bend County, Texas
- M. Louisa Tomlinson b. 1848
 d. ~1877 Fort Bend County, Texas
6. Charles Norfleet Hill b. June 1846 Waverly Plantation, Brazoria County, Texas
 d. August 10, 1902 Sandy Point, Brazoria County, Texas
- married March 5, 1873
- Q. B. Cash b. 1856 Sandy Point, Brazoria County, Texas
 d. November 29, 1933 Corpus Christi, Texas
- a. John Harvey Hill (1874-before 1933)
 b. E. (Luana) H. Hill (1876-?)
 c. Rose P. Hill (June 18, 1879-?)
 d. Charles Norfleet Hill Jr. (1887-1933)
 e. William G. Hill (1890-before 1942)
- B. James M. Westall b. ~1809-1810 North Carolina ?
 d. ~ August 10, 1833 Westall Plantation (Cholera) (August 15, 1833 date coffin made \$24.00)

- C. **Andrew E. Westall** b. September 13, 1813 Tennessee
 d. January 1869 Brazoria County, Texas
 m. 1st December 31, 1833 San Felipe de Austin
 Elizabeth Mansfield Henrie b. July 4, 1816 Cincinnati, Ohio (Major Arthur Henrie)
 d. March 12, 1852 Brazoria County, Texas (buried Gulf Prairie Cemetery)
1. Infant unnamed b. 1835 d. 1835
 2. Anna Eliza Westall b. ~1840 (Mrs. Gerard B. Munson)
 3. **Thomas Henrie Westall** b. ~ 1843
 d. December 26, 1876
 m. November 15, 1868
 Ann Elizabeth Tinsley b. March 18, 1849
 a. Mary Westall b. September 1869 d. died young
 b. Arthur Henrie Westall b. December 8, 1872
 c. Ernest Lynwood Westall b. September 25, 1875
 4. Charlotte K. Westall b. ~1847
 5. Adelia G. Westall b. August 6, 1848 d. April 23, 1912 (Mrs. Joseph Malcolm Tinsley)
 6. Lotte Westall b. ~ 1849
 7. Unnamed Infant d. March 11, 1852
- m. 2nd February 15, 1855
 Mary M. Bates b. ~1834 d. before 1869 maybe after the birth of her last child
1. Richard Westall b. ~1857
 2. Mary Beall Westall b. ~1859 married William Tyler McNeel 1881
 3. Amelia R. Westall b. ~1860 Mrs. Benjamin F. Rowe
 4. Langdon Westall b. ~ 1861 d. February 14, 1880
 5. Joseph Bates Westall b. ~1864 married Eve Gee February 24, 1897
 6. Annie R. Westall b. ~1868 married Emanuel A. Hawkins May 25, 1893
- D. Emeline Westall b. 1814 or 1815 Tennessee
 d. ~ August 17, 1833 Westall Plantation (Cholera) (August 17 date coffin was made
 \$24.00 charged to her father and mother's estate)
- E. Ann Augusta Westall b. August, 16, 1816 Tennessee
 d. March 24, 1848 (buried McNeel Cemetery Clemens Prison Farm)
 m. May 25, 1833 Brazoria County, Texas
 John Greenville McNeel b. October 23, 1801 Kentucky
 d. August 17, 1876 Brazoria County, Texas
1. Elizabeth McNeel b. January 5, 1836- d. August 8, 1839
 2. George Washington McNeel 1838- ~1863
 3. Robert McNeel b. June 12, 1840- d. June 14, 1841
 4. John Greenville McNeel 1842- ~1893
 5. Olivia McNeel b. May 25, 1845 d. August 1845
 6. Morgan Louis Shelby McNeel b. October 3, 1846 d. August 19, 1874
- F. **Henson G. Westall** b. ~1820 Tennessee
 d. January 27, 1853 Bell Grove Plantation, Brazoria County, Texas
 m. 1st February 23, 1842 Brazoria County, Texas
 Mrs. Harriet D. Ferguson d. July 4, 1849
1. Andrew E. Westall Jr. b. ~1844
 2. Eliza M. Westall b. ~1847
 3. Infant b. June 30, 1849 d. few days after birth
- m. 2nd 1851 Galveston, Texas
 Emily T. Yerby b. 1832 Mississippi (Married 2nd Henry C. Lloyd)
1. Ann McNeel Westall b. June 22, 1852 d. October 5, 1862

Appendix B
Henson G. Westall Plantation Deed Records

| GRANTORS | GRANTEES | Kind of Instrument | Book | Page | Month | Day | Year | Acres | Description |
|------------------------------|-----------------------------------|--------------------|------|--------|-------|-----|------|-------|---|
| Mexican Government | Stephen F. Austin | Deed | B | 608 | May | 31 | 1828 | | Stephen F. Austin 7 1/3 League Tract |
| William G. Eliza M. Hill | Henson G. Westall | Deed | D | 432/33 | Oct | 4 | 1842 | 730 | Love & affection for her brother |
| Henson G. Westall | John Adriance | Mortgage | D | 355/56 | March | 24 | 1847 | 730 | \$410.12 note |
| Henson G. Westall | Morgan L. Smith | Mortgage | D | 356/57 | March | 24 | 1847 | 730 | \$1235.18 note |
| William G. Hill | Henson G. Westall | Mortgage | E | 43/44 | Nov | 13 | 1848 | slave | 6 slaves notes to other parties by Hill & Westall |
| Henson G. Westall | Morgan L. Smith | Mortgage | E | 371/72 | March | 9 | 1850 | 400 | \$1600 separate tract |
| Morgan L. Smith | Henson G. Westall | Deed | E | 415/16 | March | 9 | 1850 | 400 | \$2400 Copes Place |
| Henson G. Westall | I.R. Eliza Lewis | Deed | E | 548/50 | Nov | 18 | 1850 | 400 | Slaves & \$\$ to cover Price |
| William G. Hill Executor | Andrew E. Westall | Deed | | | Nov | | 1854 | 730 | \$12.50/ acre |
| Andrew E. Emily Westall | I. T. Tinsley | Deed | M | 13/15 | Oct | 19 | 1869 | 730 | \$617 mortgage initial by Morgan L. Smith turned over to Tinsley released by children |
| I. T. Tinsley | Annie Tinsley Westall | Deed | N | 35/36 | Feb | 3 | 1870 | 730 | Gift to his daughter |
| Annie T. Cross | Ernest Westall Aurthur H. Westall | Deed | 47 | 635/36 | March | 5 | 1896 | 637 | For valuable consideration |
| A. H. Westall E. L. Westall | L. C. Masterson trustee | DT | 9 | 505/10 | Sept | 13 | 1899 | 637 | \$255 debt to Harris Masterson |
| E. L. Westall | L. C. Masterson trustee | DT | 10 | 9/13 | Nov | 28 | 1899 | 637 | ½ Interest \$500 note |
| Ernest L. Daisy J. Westall | T. L. Smith | Deed | 49 | 433/35 | Feb | 27 | 1900 | 732 | \$200 + 5 notes \$226 x 5 ½ interest |
| L. D. Williams A. H. Westall | F. H. Stewart H. Buchanan | DT | 11 | 534/37 | June | 21 | 1902 | 731 | \$4270 note |
| L. D. Williams | A. H. Westall E. L. Westall | Release | 12 | 191/93 | April | 18 | 1903 | 637 | Release notes due Harris Masterson |
| Harris Masterson | E. L. Westall | Release | 16 | 454/55 | March | 16 | 1909 | 637 | Release ½ interest |
| A. H. Dora Westall | A. J. Sharp | Deed | 62 | 348/49 | April | 17 | 1903 | 637 | \$1592.50 ½ Interest |
| A. J. Sharp | Harris Masterson | Deed | 62 | 350/51 | May | 4 | 1903 | 637 | \$1592.50 |

Appendix C
Slave List Henson G. Westall Estate 1853

| | | | |
|------------|-------|------|----|
| George | Man | aged | 32 |
| Henry | Man | | 25 |
| Griffin | Man | | 23 |
| Ned | Boy | | 13 |
| Joe Banton | Boy | | 5 |
| Chatherine | Woman | | 31 |
| Clarissa | Woman | | 28 |
| Dony | Woman | | 20 |
| Celia | Woman | | 22 |
| Sarah | Woman | | 30 |
| Caroline | Woman | | 18 |
| Jane | Girl | | 11 |
| Lucy | Girl | | 9 |
| Patsy | Girl | | 7 |
| Almira | Girl | | 2 |
| Martha | Girl | | 4 |

BIBLIOGRAPHY

Primary Sources

UNPUBLISHED PAPERS

Brazoria County Historical Museum Library, Angleton, Texas

Westall Family File 124

Westall Plantation File

Texas State Archives, Austin, Texas

Republic of Texas Claims 1835-1846

Texas Agricultural Census 1850

Texas Agricultural Census 1860

Texas Agricultural Census 1870

NEWSPAPERS AND PERIODICALS

Democrat and Planter, Columbia, Texas

GOVERNMENT DOCUMENTS

Deed Records Brazoria County, County Clerk's Office, Angleton, Texas

Probate Records Brazoria County, County Clerk's Office, Brazoria County Courthouse,
Angleton, Texas

Brazoria County Tax Records on microfilm Brazoria County Historical Museum, Angleton,
Texas

Federal Population Schedule, Seventh Census of the United States.

1850 The State of Texas, Brazoria County

"Schedule 2—Slave Inhabitants in the County of Brazoria, Texas"

Federal Population Schedule, Eighth Census of the United States.

1860 The State of Texas, Brazoria County

"Schedule 2—Slave Inhabitants in the County of Brazoria, Texas"

Federal Population Schedule, Ninth Census of the United States.

1870

Federal Population Schedule, Tenth Census of the United States.

1880

Secondary Sources

BOOKS, ESSAYS, THESES, AND DISSERTATIONS

Boddie, Mary Delaney, Thunder on the Brazos, Taylor Publishing Company, 1978

Camfield, Thomas W., The Westalls and Their Kin, private printing, 1998

Haggard, J. Villasana, "Cholera Epidemic 1833-1834", Southwestern Historical Quarterly, January, 1937, Vol. XL, No.3